

# ***Ramesh***<sup>®</sup> **PUMPS**

**50**  
**YEARS**  
SINCE : 1966



**PRODUCT MANUAL**

Quality Delivers..... Forever



# PRODUCT MANUAL

# LIST OF PRODUCTS

## CONTENTS

## PAGE NO.

COMPANY PROFILE	1 - 5
SELFPRIMING MONOBLOC PUMPS	6
DOMESTIC SELF PRIMING MONOBLOC PUMPS (SLOW SPEED)	7
CENTRIFUGAL MONOBLOC PUMPS	8
CENTRIFUGAL MULTI STAGE MONOBLOC PUMPS	9
JET PUMPS	10
SINGLE PHASE OPENWELL PUMPS	11
MULTISTAGE OPENWELL PUMPS	12
THREE PHASE OPENWELL PUMPS	13
3" SUBMERSIBLE PUMP SET & 4" QT SERIES	14
4" SUBMERSIBLE PUMP SET	15 - 16
4" FULLY STAINLESS STEEL SUBMERSIBLE PUMP SET	17
6" QT SERIES SUBMERSIBLE PUMP SET	18
6" RADIAL FLOW SUBMERSIBLE PUMP SET	19 - 20
6" MIXED FLOW SUBMERSIBLE PUMP SET	21 - 22
6" STAINLESS STEEL SUBMERSIBLE PUMP SET ( 50 Feet /Stage)	23 - 24
VERTICAL OPENWELL SUBMERSIBLE PUMP	25
<b>SPECIAL PURPOSE</b>	
DOMESTIC PRESSURE BOOSTER PUMPS	26
DE WATERING PUMPS	26
RECIPROCATING AIR COMPRESSORS	27
<b>INDUSTRIAL PURPOSE</b>	
ELECTRIC MOTORS	28
<b>USEFULL GUIDE</b>	
DISCHARGE MEASUREMENT CHART	29
CABLE SELECTION CHART	30
FRICITION HEAD LOSS CHART	31
MARKETING NETWORK	32

## Company profile

**Ramesh Hitechk Pumps Private Limited** started its operation in 1966, manufacturing Pumps and Motors. Now we have grown into one of the leading manufacturers of Pumps in India. We produce 650 varieties of pumps to cater to the agriculture and domestic segments.

Our vision is to produce quality products through cost-effective means, to the complete satisfaction of our customers. We design and develop our products keeping in mind Indian conditions and hence our pumps are maintenance free. We use modern computer aided design, state-of-the-art manufacturing process, CNC Machines and stringent inspection procedures, in order to manufacture quality products consistently. We have a young and dynamic team of workforce with a commitment to produce quality products. We have a modern testing department where all the pumps manufactured by us are tested as per relevant IS specifications.

Most ranges of our Jet Pumps, Monobloc Pumps, Submersible Pumps and Openwell Submersible Monoblocs & Self priming pumps are ISI marked. We have very effective dealer network all over India that provides the best after sales services to our customers. We have also been awarded ISO 9001-2008, Certification for maintaining Quality Systems. We have obtained 5 Star rating for a wide range of Submersible Pumpsets and Openwell monobloc pumps.

Ramesh Hitechk Pumps Private Limited, having its Foundry Unit for the past 25 Years is now having a modernized foundry unit at Karayampalayam Village, Mayilampatti Post, Coimbatore – 641 014.

# Company Infrastructure

**Ramesh**<sup>®</sup>  
SINCE : 1966 PUMPS



Quality Delivers.... Forever





# CERTIFICATE OF REGISTRATION

The Management System of

## **RAMESH HITECHK PUMPS PRIVATE LIMITED**

Registered Office & Works Unit - I: 1040, Bharathiyar Road,  
Pappanaickenpalayam, Coimbatore - 641 037, Tamil Nadu, India  
Works Unit - II: 22, Premier Industrial Estate, Avarampalayam Road,  
Ganapathy (Post), Coimbatore - 641 037, Tamil Nadu, India

has been assessed and complying with

**ISO 9001:2008**

for the following activities

**Design, Manufacture, Supply and Servicing of  
Centrifugal Regenerative Self Priming Pumpsets,  
Centrifugal Monobloc Pumpsets, Centrifugal Jet Pumpsets,  
Borewell Submersible Pumpsets, Openwell Submersible  
Pumpsets and Electric Motors**

Date of Issue: 25 May 2014

Date of Expiry: 24 April 2017

Initial Certification: 26 April 2011

Certificate No. 683077

The validity of this certificate can be verified from the following website

[www.gicg.co.uk](http://www.gicg.co.uk)

**Guardian Independent Certification Ltd**

Registered in England

Sovereign House 212-224 Shaftsbury Avenue London England WC2H 8ND

Accredited by Member of the IAF MLA



IS : 8472



CM/L No.6224153

**SELF PRIMING MONOBLOC PUMPS**

SELF PRIMING 2880 RPM  
SLM - 50/N



SELF PRIMING 2880 RPM  
SLM - 50

SELF PRIMING 2880 RPM  
SKV - 50



**RANGE**

- 0.50 Hp to 1.0 HP
- Pipe Size 25 X 25 mm
- Head 20 to 130 Feet
- Discharge 3500 to 900 Lph
- Voltage 230 V, 1 Phase

**FEATURES**

- Stainless Steel Shaft
- Fitted with Thermal Overload Protector
- Forged Gunmetal Impellers
- Aluminium & Cast Iron Body

**APPLICATIONS**

- Suitable for Portable Water Transfer Applications
- Overhead Storage Water Tank Filling
- Domestic Water Supply
- Lawn and Garden Watering

**PERFORMANCE CHART FOR SINGLE PHASE SELFPRIMING MONOBLOC PUMPS**

PUMP TYPE	PUMP SIZE IN mm	DISCHARGE IN LITRE PER HOUR AT VARIOUS TOTAL HEADS IN FEET/MTS													
		20 FT	30 FT	40 FT	50 FT	60 FT	70 FT	80 FT	90 FT	100 FT	110 FT	120 FT	130 FT	140FT	150FT
		6 MTS	9 MTS	12 MTS	15 MTS	18 MTS	21 MTS	24 MTS	27 MTS	30 MTS	33 MTS	36 MTS	39 MTS	42MTS	45MTS
0.50 HP MINI SELE PRIMING SLM-25	25X25	1800	1550	1300	1150	900	700								
0.5 HP SELF PRIMING SLM-50/N & CI	25X25	2000	1850	1600	1450	1300	1150	1000	800	600					
0.5 HP SELF PRIMING SLM-50	25X25	2200	2100	2000	1850	1750	1700	1600	1350	1000	750				
0.50 HP SELF PRIMING SKV - 50	25X25	2600	2400	2200	1950	1850	1800	1700	1600	1200	850				
1HP SELF PRIMING SLM-100/N	25X25	3200	2900	2600	2450	2300	2100	1900	1700	1500	1250	1000	800	600	
1HP SELF PRIMING SLM-100	25X25	3500	3400	3300	3150	3000	2800	2500	2300	2000	1700	1400	1100	900	600
0.5 HP SHALLOW WELL -SWJ 50	25X25	3300	3200	3150	3000	2900	2500	2000	1300	800					
1 HP SHALLOW WELL -SWJ 100	25X25	3600	3500	3400	3300	3250	3000	2700	2400	1800	1400	1200	900		
0.5 HP DOMESTIC MONOBLOC DSM-2 & DSM-2N	25X25	2800	2500	2200	1850	1600	1350	1100	850						
1.0 HP DOMESTIC MONOBLOC DSM-3	25X25	3500	3300	3000	2800	2500	2200	1900	1700	1500	1400	1200	900		

Recommended Head Range

## DOMESTIC SELF PRIMING MONOBLOCK PUMPS SLOW SPEED (1440 RPM)



SELF PRIMING 1440 RPM

### RANGE

- 0.50 Hp to 1.0 HP
- Pipe Size 25 X 25 mm
- Head 20 to 130 Feet
- Discharge 3500 to 900 Lph
- Voltage 230 V, 1 Phase

### APPLICATION

- Proven Pump for Corporation Water Suction Purpose
- Pressure Boosting for Residential Buildings
- Over Head Storage Water Tank Filling
- All Application requiring Self Priming Action upto 8 Metres

### PERFORMANCE CHART FOR SINGLE PHASE DOMESTIC SELFPRIMING MONOBLOC PUMPS

PUMP TYPE	PUMP SIZE IN mm	DISCHARGE IN LITRE PER HOUR AT VARIOUS TOTAL HEADS IN FEET/MTS													
		20 FT	30 FT	40 FT	50 FT	60 FT	70 FT	80 FT	90 FT	100 FT	110 FT	120 FT	130 FT	140FT	150FT
		6 MTS	9 MTS	12 MTS	15 MTS	18 MTS	21 MTS	24 MTS	27 MTS	30 MTS	33 MTS	36 MTS	39 MTS	42MTS	45MTS
0.5 HP DOMESTIC MONOBLOC DSM-2 & DSM-2N	25X25	2800	2500	2200	1850	1600	1350	1100	850						
1.0 HP DOMESTIC MONOBLOC DSM-3	25X25	3500	3300	3000	2800	2500	2200	1900	1700	1500	1400	1200	900		

### PERFORMANCE CHART FOR SINGLE PHASE SHALLOW WELL JET PUMPS

0.5 HP SHALLOW WELL -SWJ 50	25X25	3300	3200	3150	3000	2900	2500	2000	1300	800					
1 HP SHALLOW WELL -SWJ 100	25X25	3600	3500	3400	3300	3250	3000	2700	2400	1800	1400	1200	900		

➔ Recommended Head Range

## SHALLOW WELL JET PUMPS



### RANGE

- 0.50 Hp to 1.0 Hp
- Pipe Size 25 X 25 Mm
- Head 20 Feet to 130 Feet
- Dischagre 3600 to 900 Lph
- Voltage 230 V, 1 Phase

### APPLICATION

- Domestic Water Supply
- Pressure Boosting for Residential Water Supply
- Over Head Storage Water Tank Filling
- Car Washing
- All Application requiring Self Pumping Action upto 6 Metres

IS : 9079



CM/L No. 6119055

**FLOWMAX MONOBLOC PUMP**



**Monobloc  
0.5 HP MH (AL) 1X1**

**RANGE**

- 0.50 Hp to 3.0 HP
- Pipe Size 25 to 75 mm
- Head 20 Feet to 60 Feet
- Discharge 40000 to 6500 Lph
- Voltage 230 V, 1 Phase &
- 415 V, 2 Phase & 3 Phase

**APPLICATION**

- Over Head Storage Water Tank Filling
- Domestic Water Supply
- Garden Irrigation Small Farm Irrigation from Ponds
- Water Supply for Commercial Establishments like Hotels, Lodgings, etc.



**Monobloc  
0.5 HP 1X1**



**Monobloc  
2 HP 3X2.5**

**PERFORMANCE CHART FOR SINGLE PHASE CENTRIFUGAL MONOBLOC PUMPS**

PUMP TYPE	PUMP SIZE IN mm	DISCHARGE IN LITRE PER HOUR AT VARIOUS TOTAL HEADS IN FEET/MTS																			
		20 FT 6 MTS	30 FT 9 MTS	40 FT 12 MTS	50 FT 15 MTS	60 FT 18 MTS	70 FT 21 MTS	80 FT 24 MTS	90 FT 27 MTS	100 FT 30 MTS	110 FT 33 MTS	120 FT 36 MTS	130 FT 39 MTS	140FT 42MTS	150FT 45MT	160FT 48MTS	180FT 55MTS	200FT 61MTS	215FT 65MTS	230FT 70M	250FT 75MTS
0.5 HP FLOWMAX - 1/MH	25X25	5800	5600	5400	4200																
0.5 HP FLOWMAX - 1A	25X25		6500	6000	5100	4000	2000														
0.5 HP FLOWMAX - 1	25X25			7500	6500	5500	3400														
0.5 HP FLOWMAX - 1/LH	38X38	13000	10000	6500	3000																
0.5 HP FLOWMAX - 1/HH	25X25			6300	6100	5600	4000	1800													
1 HP FLOWMAX - 2/HH	25X25			6500	6400	6300	6150	6000	5200	3800	2000	1000(35 Mts)									
1 HP FLOWMAX - 2	32X25				9000	7500	5500	5000	3000	1100											
1 HP FLOWMAX - 2/MH	38X38	21000	19500	17000	13000																
1 HP FLOWMAX - 2/LH	50X50	22000	20000	16000	11000																
1.5 HP FLOWMAX - 3/LH	50X50		28500	25200	20000	9500															
1.5 HP FLOWMAX - 3/MH	50X38		26000	23500	18000	10300															
1.5 HP FLOWMAX - 3/HH	25X25			7200	7000	6800	6600	6200	6000	5750	5500	5400	3600	1500							
2 HP FLOWMAX - 4/LH (1PH & 2PH)	75X65	40000	32000	25000	11000																
2 HP FLOWMAX - 4/MH(1PH & 2PH)	65X50			31000	24000	15000															
2 HP FLOWMAX - 4/25(1PH & 2PH)	65X50	30000	38500	26000	23400	20700	17100	13400	8000(25 Mts)												
2 HP FLOWMAX - 4	50X50			30000	22000	16000	12000														
2 HP FLOWMAX - 4/HH -1	38X38							13600	13000	12500	10000	7000	5500								
2 HP FLOWMAX - 4/HH -2	38X32							12000	11200	10600	8000	6900	5000								
2 HP FLOWMAX - 4/50HH	25X25							7500	7000	6500	6000	5800	5300	4500	3500	2500					
3 HP FLOWMAX - 565(3 PH & 2PH)	65X65	35000	32500	32000	31500	31000	24500	13500													

➔ Recommended Head Range

**Multistage Monobloc Pump**



**Multi Stage Monobloc  
1 HP 3 Stage**



**Multi Stage Monobloc  
2 HP 5 Stage**



**Multi Stage Monobloc  
2 HP 5 Stage(SS-304)**

**SPECIAL FEATURES :**

- Compact Size for Easy Handling
- Suitable for Wide Voltage Operation - (180to 250 Volts)
- Corrosion free fully Stainless Steel Pumps
- Cost Effective & High Performance
- Non over loading characteristics through out Head Range
- Heavy Dutyball Bearings
- Fitted with Thermal overload Protector
- Pump Designed to avoid Dry-run Related Problems

**IMPORTANT NOTE**

- Install Proper Size Pipes Recommended
- Reduce number of bends in delivery Pipe Line
- Do not use more than one bend in Suction Line
- Use ISI Marked Foot Valves
- For Pumps having 25x25 Pipe do not use 20mm or 12.7 mm Pipes, it will affect the performance of the Pump due to Pipe Friction
- To avoid Overloading and Cavitation, install Suction Pipe within 10 To 17 Feet
- Use 1/18 Copper Wire for 1/2 Hp 3/20 Copper Wires for 1 HP, 7/20 Copper Wire for 1.5hp and 2 HP Monobloc Pumps

**APPLICATION :**

- High Pressure Application (RO Plant)
- Sprinkler Irrigation in Estate
- Pumping from Sumps for High-rise Building and Industries
- Boosting Applications for Domestic, Commercial & Industrial Buildings
- Boiler Feed Applications
- Water & Industrial Washing Purpose

**PERFORMANCE CHART FOR CENTRIFUGAL MULTISTAGE MONOBLOC PUMPS**

PUMP TYPE	PUMP SIZE IN mm	DISCHARGE IN LITRE PER HOUR AT VARIOUS TOTAL HEADS IN FEET/MTS																			
		20 FT 6 MTS	30 FT 9 MTS	40 FT 12 MTS	50 FT 15 MTS	60 FT 18 MTS	70 FT 21 MTS	80 FT 24 MTS	90 FT 27 MTS	100 FT 30 MTS	110 FT 33 MTS	120 FT 36 MTS	130 FT 39 MTS	140FT 42MTS	150FT 45MS	160FT 48MTS	180FT 55MTS	200FT 61MTS	215FT 65MTS	230FT 70MTS	250FT 75MTS
1 HP 3 STAGE MONOBLOC (FM-2/3 SI)	32X25		10200	10000	9650	9800	8450	7600	6800	6000	4400	2700	1000								
2 HP 5 STAGE MONOBLOC (FM-4/5SI)	32X32				11200	11000	10600	10300	10000	9550	9200	8800	8400	8000	7500	6900	5400	3700	1500		
3 HP 6 STAGE MONOBLOC (FM-5/6SI) - 3Ph	32X32					11200	11000	10600	10300	10000	9550	9200	8800	8400	8000	7500	6900	5400	3200		

➔ Recommended Head Range

IS : 12225



CM/L No.2405945

**JET PUMPS**



1 HP JET PUMP (REGULAR)



1 HP 2 STAGE (MVJ-140)



1 HP 2 STAGE (MVJ-180)

**RANGE**

- 0.50 HP to 2.0 HP
- Head 30 Feet to 350 Feet
- Discharge -2200 to 400 Lph
- Voltage 230 V, 1 Phase & 415 V, 3 Phase

**APPLICATION**

- Pumping Water from Bores of Diameter 3", 4" & 4.5"
- Pumping Water from Open Wells
- Over Head Storage Water Tank Filling
- Domestic Water Supply
- Can be Safely Erected inside the Building, away from the Borewell for Better Security

**PERFORMANCE CHART FOR SINGLE PHASE CENTRIFUGAL JET PUMPS**

PUMP TYPE	TYPE	DELIVERY HEAD IN FEET	DISCHARGE IN LITRE PER HOURS AT VARIOUS DEPTH OF LOW WATER LEVEL IN FEET/MTS														
			30 FT	40 FT	60 FT	80 FT	100 FT	120 FT	140 FT	160 FT	180 FT	200 FT	220 FT	250 FT	300 FT	350 FT	
			9 MTS	12 MTS	18 MTS	24 MTS	30 MTS	36 MTS	42 MTS	49 MTS	55 MTS	61 MTS	67 MTS	76 MTS	91 MTS	106 MTS	
0.50 HP JET PUMP	MVJ - 80	45	1840	1670	1300	920											
1.00 HP JET PUMP	MVJ - 110	60	2200	2120	1750	1380	950	700									
1 HP 2 STAGE JET PUMP	MVJ - 140	65	2400	1950	1600	1450	1330	1200	900								
1 HP 2 STAGE JET PUMP	MVJ - 180	65	2500	2130	1760	1500	1450	1330	1200	900	520						
1.50 HP JET PUMP	MVJ - 150	75	2200	2120	1775	1535	1470	1300	1150	875							
1.50 HP 2 STAGE JET PUMP	MVJ - 250	75	2200	2120	1770	1600	1475	1300	1150	950	800	700	650	600			
2.00 HP 2 STAGE JET PUMP	MVJ - 350	90	2200	2150	2000	1800	1700	1600	1400	1300	1200	1000	900	850	600	400	

Recommended Head Range

**SINGLE PHASE OPENWELL SUBMERSIBLE PUMPS**



1 HP OM SERIES OPENWELL



1 HP OPENWELL



1.5 HP 2 STAGE OPENWELL

**RANGE**

- 0.5 HP to 2 HP
- Pipe Size 25 to 75 mm
- Head 20 Feet to 140 Feet
- Discharge 38000 to 2000 Lph
- Voltage 230 V, 1 Phase & 415 V, 2 Phase & 3 Phase

**APPLICATION**

- Domestic Water Supply
- Overhead Storage Water Tank Filling from Sump
- Water Supply for Commercial Establishments like Hotels, Lodgings, etc.
- Garden Irrigations

**PERFORMANCE CHART FOR SINGLE & THREE PHASE OPENWELL SUBMERSIBLE PUMPSET**

PUMP TYPE	PUMP SIZE IN mm	DISCHARGE IN LITRE PER HOUR AT VARIOUS TOTAL HEADS IN FEET/MTS																
		20 FT 6 MTS	30 FT 9 MTS	40 FT 12 MTS	50 FT 15 MTS	60 FT 18 MTS	70 FT 21 MTS	80 FT 24 MTS	90 FT 27 MTS	100 FT 30 MTS	105 FT 32 MTS	110 FT 34 MTS	120 FT 37 MTS	130 FT 40 MTS	147 FT 45 MTS	157 FT 48 MTS	165 FT 50 MTS	180 FT 55 MTS
0.5 HP OPENWELL ( OMB - 0.5 & OM - 0.50)	25X25	9800	9400	9000	8200	7200	3000											
1 HP OPENWELL ( OMB - 1 & OM - 1)	32X25				11800	11500	10000	7600	5400	4000								
1 HP OPENWELL ( OMB - 1/HH)	25X25					7000	6500	5750	5000	4200	3250	2500	1000 (35 Mts)					
1 HP OPENWELL ( OMB- 1/LH)	50X50	22000	19500	15000	10000													
1.50 HP OPENWELL ( OM - 1.50/42M)	25 X 25				9000	8700	8300	7500	7100	6500	5800	5200	3800	2200	1200 (42 Mts)			
1.50 HP OPENWELL ( OMB - 1.50/HH)	32 X 32						10500	9500	8700	8000	7200	6700	5800	4500	2500			
2 HP OPENWELL ( OMB - 2)	50 X 50	31500	28000	26500	21000	16000	8000											
2 HP OPENWELL ( OMB - 2 / 25 Mts)	50 X 50	30500	29500	27200	24700	21750	18300	14400	10500 (25 Mtr)									
2 HP OPENWELL ( OMB - 2 / MH)	65 x 50	33000	30000	28000	22000	14000												
2 HP OPENWELL ( OMB - 2/LH)	75 X 65	38000	31000	25000	12000													
2 HP OPENWELL ( OMB - 2/HH)	38 X 38				9500	9250	8750	7700	7200	6800	4600							
2 HP OPENWELL ( OMB - 2/50 HH)	25 X 25		8300	8000	7500	7000	7400	7000	6500	6200	5400	5200	4600	4000	3000	2000	1000	

➔ Recommended Head Range

**MULTI STAGE OPENWELL SUBMERSIBLE PUMPS**



**1 HP 3 STAGE PUMP**



**2 HP 5 STAGE PUMP**

Ramesh openwell submersible pumpsets are manufactured using quality raw materials selected after strict inspection Procedures. The pump and the motor are tested individually to pass through various stringent quality control tests as per I.S. specifications.

**SPECIAL FEATURES**

- Compact Size for Easy Handling
- Suitable for Wide Voltage Operation - (180 to 250 Volts)
- Corrosion free fully Stainless Steel Pumps
- Cost Effective & High Performance
- Non overload characteristics through out Head Range
- Heavy type of Journal Bush Bearing used
- Fitted with Thermal Over Load Protector
- Pumps Designed to Avoid Dry-run Related Problems

**APPLICATION**

- High Pressure Application (RO Plant)
- Sprinkler Irrigation in Estate
- Pumping from Sumps for High-rise Building and Industries
- Boosting Application for Domestic, Commercial & Industrial Buildings
- Boiler Feed Application
- Water & Industrial Washing Purpose

**PERFORMANCE CHART FOR SINGLE & THREE PHASE OPENWELL SUBMERSIBLE PUMPSET**

PUMP TYPE	PUMP SIZE IN mm	DISCHARGE IN LITRE PER HOUR AT VARIOUS TOTAL HEADS IN FEET/MTS																				
		20 FT 6 MTS	30 FT 9 MTS	40 FT 12 MTS	50 FT 15 MTS	60 FT 18 MTS	70 FT 21 MTS	80 FT 24 MTS	90 FT 27 MTS	100 FT 30 MTS	105 FT 32 MTS	110 FT 34 MTS	120 FT 37 MTS	130 FT 40 MTS	147 FT 45 MTS	157 FT 48 MTS	165 FT 50 MTS	180 FT 55 MTS	197 FT 60 MTS	213 FT 65 MTS	230 FT 70 MTS	250 FT 76 MTS
1HP 3 STAGE HOR OPENWELL	Del - 25mm					8250	7600	6900	6300	5500	4900	4200	2750	1300								
2 HP 5 STAGE HOR OPENWELL	Del - 38mm			12500	12200	11900	11600	11300	10950	10600	10300	10100	9700	9300	8700	8100	7500	6700	5300	3000		
3 HP 6 STAGE HOR OPENWELL 3 Phase & 2 Phase	Del - 50mm						13300	13000	12700	12400	12100	11800	11600	11300	11000	10800	10300	9000	8200	6500	5000	4500

➔ Recommended Head Range

IS : 14220



CM/L No.6532972



CB - 100 OPENWELL

**OPENWELL SUBMERSIBLE PUMPS**



OM SERIES OPENWELL

**APPLICATION**

- Open Well Pumping for Irrigation
- River & Canal Irrigation
- Sprinkler & Drip Irrigation Systems
- Pumping from Sump for High Rise Building
- Industry & Commercial Establishments

**RANGE**

- 3.0 HP to 10 HP
- Delivery Size 38 to 100 mm
- Head 80 Feet to 170 Feet
- Discharge 1900 Lpm to 80 Lpm
- Voltage 415 V, 3 Phase & 2 Phase

**PERFORMANCE CHART FOR THREE PHASE OPENWELL SUBMERSIBLE PUMPSET**

PUMP TYPE	PUMP SIZE IN mm	DISCHARGE IN LITRE PER MINUTES AT VARIOUS TOTAL HEADS IN FEET/MTS															
		20 FT 6 MTS	30 FT 9 MTS	40 FT 12 MTS	50 FT 15 MTS	60 FT 18 MTS	70 FT 21 MTS	80 FT 24 MTS	90 FT 27 MTS	100 FT 30 MTS	110 FT 33 MTS	120 FT 36 MTS	130 FT 39 MTS	140 FT 42 MTS	150 FT 45 MTS	160 FT 48 MTS	170 FT 52 MTS
3.0 HP OPENWELL ( OMB - 350)	65X50		650	600	560	480	420	250									
3.0 HP OPENWELL H.H (OMB - 350 H.H)	65X50			700	670	650	600	520	400	270	140						
3.0 HP OPENWELL H.H (OMB -350/38 Mts)	50X38			550	540	540	530	490	450	380	330	240	140				
5.0 HP OPENWELL (OMB – 550 /43 Mts)	65 X 50		680	675	670	660	650	640	630	620	570	550	480	320			
5.0 HP OPENWELL (OMB – 550 /48 Mts)	50 X 50		480	460	450	440	435	430	425	420	410	380	340	320	170	80	
5.0 HP OPENWELL (OMB-565)	75 X 65		1120	960	900	780	660	480	240								
5.0 HP OPENWELL (OMB-575/LH)	100 X 75	1600	1200	1000	900												
5.0 HP OPENWELL (OMB-5100/LH)	100 X 100	1900	1750	1200	850												
7.5 HP OPENWELL (OMB-750/HH)	65 X 50		900	880	860	840	800	780	730	690	630	580	500	400	300	220	90
7.5 HP OPENWELL (OMB-765)	75 X 65		1350	1300	1200	1160	1050	900	800	750	500	400	200 (38 Mtr)				
7.5 HP OPENWELL (OMB-775/LH)	100 X 75	1750	1560	1440	1200	1080	840	550									
10.0 HP OPENWELL (OMB-1050)	65 X 50					1300	1250	1200	1150	1100	1050	1000	900	850	750	650	500
10.0 HP OPENWELL (OMB-1065)	75 X 65				1500	1400	1350	1300	1250	1175	1050	950	850	600	300		
10.0 HP OPENWELL (OMB-1075/LH)	100 X 75		1800	1710	1610	1450	1360	1200	950	690							

➔ Recommended Head Range

**3" SUBMERSIBLE PUMPS**



**RANGE**

- 0.50 HP to 1.5 HP
- Delivery Size 25 mm
- Head 20 Feet to 300 Feet
- Discharge 3450 to 500 Lph
- Voltage 230 V, single Phase

<b>PERFORMANCE CHART FOR 3" (75 mm) SUBMERSIBLE PUMPS</b>																	
PUMP TYPE	PIPE SIZE IN mm	DISCHARGE IN LITRES PER HOUR AT VARIOUS TOTAL HEADS IN FEET															
		20	40	60	80	100	120	140	160	180	200	220	230	240	260	280	300
0.5HP 10 STAGE	25	2800	2400	2100	1500	1100	500										
0.75HP 13 STAGE	25	3000	2700	2400	2150	1800	1500	1000	600								
1 HP 18 STAGE	25	3400	3250	3000	2800	2650	2400	2250	2000	1800	1500	1100	900	700			
1.50 HP 27 STAGE	25	3450	3350	3150	2900	2750	2500	2400	2250	2100	2000	1800	1700	1600	1400	1100	750

Recommended Head Range

**APPLICATION FOR 3" & 4" QT SERIES**

- Pumping Water from Bores of Diameter, 4" & Above
- Public Water Supply Scheme in Urban & Rural Areas
- Industrial Water Supply

**4" SUBMERSIBLE PUMPS  
QT SERIES**



**RANGE**

- 0.50 HP to 1.5 HP
- Delivery Size 32 mm
- Head 25 Feet to 400 Feet
- Discharge 4000 to 750 Lph
- Voltage 230 V, 1 Phase

<b>PERFORMANCE CHART FOR SINGLE PHASE QT SERIES 4" ( 100mm ) SUBMERSIBLE PUMPSET</b>																		
PUMP TYPE	MODEL	PIPE SIZE IN mm	DISCHARGE IN LITRES PER HOUR AT VARIOUS TOTAL HEADS IN FEET															
			25	50	75	100	125	150	175	200	225	250	275	300	325	350	375	400
0.5 HP 6 Stage	QT - 140	32	4000	3200	2600	1900	1300	750										
0.75 HP 13 Stage	QT - 250	32	3500	3300	2800	2500	2300	2000	1800	1400	1100	800						
1.0 HP 9 Stage	QT - 225	32	4100	3700	3000	2700	2500	1900	1500	1200	900							
1.0 HP 12 Stage	QT - 275	32	3850	3500	3300	3000	2750	2500	2100	1650	1400	1250	600					
1.0 HP 16 Stage	QT - 325	32	3500	3400	3300	3000	2800	2600	2300	2000	1800	1550	1250	1000	750			
1.5 HP 18 Stage	QT - 400	32	3700	3550	3400	3300	3150	2900	2750	2600	2400	2200	1950	1650	1350	1200	1000	750

Recommended Head Range

IS : 9283



CM/L No.6095067

**4" SUBMERSIBLE PUMPS**



**RANGE**

- 0.50 HP to 7.5 HP
- Delivery Size 32 to 50 mm
- Head 25 Feet to 1800 Feet
- Discharge 21600 to 500 Lph
- Voltage 230 V, 1 Phase & 415 V, 2 Phase & 3 Phase

**APPLICATION**

- Pumping Water from Bores of Diameter, 4" & Above
- Irrigation of Agriculture including Drip & Sprinkler Systems
- Public Water Supply Scheme in Urban & Rural Areas
- Industrial Water Supply
- Water Supply & Boosting Application for Commercial Establishments like Hotels, Lodges & Hospitals

**PERFORMANCE CHART FOR SINGLE & THREE PHASE 4" (100 mm) SUBMERSIBLE PUMPS**

PUMP TYPE	MODEL	PIPE SIZE IN mm	DISCHARGE IN LITRES PER HOUR AT VARIOUS TOTAL HEADS IN MTR/FEET																							
			MTR	7	15	22	30	38	45	53	62	68	76	83	91	99	106	114	121	137	144	152	167	182	213	228
			FEET	25	50	75	100	125	150	175	200	225	250	275	300	325	350	375	400	450	475	500	550	600	700	750
0.50 HP 6 Stage	RHPP 4 - 140	32	3800	3250	2900	2500	1900	1100																		
1.0 HP 7 Stage	RHPP 4 - 175	32	6300	5750	5200	4400	3600	3000	1600																	
1.0 HP 9 Stage	RHPP 4 - 225	32	5000	4600	4400	4000	3750	3500	2600	2400	1500															
1.0 HP 12 Stage	RHPP 4 - 275	32	4000	3600	3400	3150	2900	2650	2350	2000	1650	1200	700													
1.0 HP 12 Stage (HH)	RHPP 4 - 325	32	4800	4600	4200	3900	3600	3300	3000	2650	2250	1900	1400	1000	700											
1.0HP 18 Stage	RHPP 4 - 400	32	3700	3550	3400	3300	3150	2900	2750	2600	2400	2200	1950	1650	1350	1100	900	500								
1.5 HP 15 Stage	RHPI 4 - 375	32	6400	6000	5800	5300	5000	4800	4500	4300	3900	3500	3200	2600	2200	1800	1600									
1.5 HP 18 Stage	RHPP 4 - 475	32	4700	4400	4250	4100	3900	3750	3550	3350	3150	3000	2800	2500	2200	2000	1800	1500	1000	850						
1.5 HP 22 Stage	RHPP 4 - 550	32	4150	4000	3850	3750	3600	3500	3350	3150	3100	2950	2800	2650	2550	2350	2200	2000	1600	1350	1100	500				
2.0 HP 15 Stage	RHPI 4 - 300	38	10300	9800	9200	8600	7950	7300	6600	5750	5100	4200	3000	1200												
2.0HP 18 Stage	RHPI 4 - 450	32	6500	6100	5950	5500	5250	5100	4900	4450	4100	3900	3700	3300	2900	2700	2200	1900	1600							
2.0 HP 22 Stage	RHPP 4 - 600	32	4700	4500	4350	4250	4100	3950	3800	3600	3500	3300	3200	2950	2800	2650	2550	2450	2000	1850	1600	1300	600			
2.0 HP 32 Stage	RHPI 4 - 750	32	4000	3950	3900	3800	3700	3600	3500	3400	3350	3250	3150	3100	3000	2850	2750	2650	2400	2300	2200	2000	1800	950	600	
3.0 HP 27 Stage	RHPI 4 - 700	32	5000	4500	4300	4000	3900	3850	3750	3700	3650	3600	3500	3350	3275	3200	3100	3000	2750	2500	2250	1900	1600	700		

Recommended Head Range



**V4 FULLY STAINLESS STEEL  
SUBMERSIBLE PUMPS**



**RANGE**

- 1 HP to 5 HP
- Delivery Size 32 to 38 mm
- Head 25 Feet to 1250 Feet
- Discharge 8500 to 1300 Lph
- Voltage 230 V, 1 Phase & 415 V, 2 Phase & 3 Phase

**APPLICATION**

- Pumping Water from Bores of Diameter, 4" & Above
- Irrigation of Agriculture Including Drip & Sprinkler Systems
- Public Water Supply Scheme in Urban & Rural Areas
- Industrial Water Supply
- Water Supply & Boosting Application for Commercial Establishments like Hotels, Lodges & Hospitals

**PERFORMANCE CHART FOR SINGLE & THREE PHASE (FULLY STAINLESS STEEL PUMP WITH REGULAR MOTOR)  
4" (100 mm) SUBMERSIBLE PUMPS**

PUMP TYPE	MODEL	PIPE SIZE IN mm	DISCHARGE IN LITRES PER HOUR AT VARIOUS TOTAL HEADS IN MTR/FEET																																				
			MTR	7	15	22	30	38	45	53	62	68	76	83	91	99	106	114	120	137	152	167	182	213	245	259	275	305	335	380	400								
			FEET	25	50	75	100	125	150	175	200	225	250	275	300	325	350	375	400	450	500	550	600	700	800	850	900	1000	1100	1250	1300								
1 HP 8 Stage SS	RHPI 4 - 200 S	32	8800	8000	7200	6200	5100	4200	2600	1500																													
1 HP 12 Stage SS	RHPI 4 - 300 S	32	6600	6300	6000	5500	5000	4600	4200	3600	3100	2500	1700	1000																									
1.50 HP 12 Stage SS	RHPI 4 - 325 S	32	9100	8700	8200	7700	7200	6600	5800	4800	4100	3200	2300	1650	1000																								
1.5 HP 18 Stage SS	RHPI 4 - 450 S	32	6700	6500	6300	6100	5600	5000	4700	4400	3900	3700	3500	3200	2900	2500	1900	1400	900																				
2 HP 16 Stage SS	RHPI 4 - 425 S	32	9200	8800	8400	8100	7700	7300	6800	6100	5500	4700	4050	3200	2500	2100	1900	1650																					
2 HP 22 Stage SS	RHPI 4 - 575 S	32	6800	6700	6600	6400	6200	6000	5800	5500	5300	5000	4800	4500	4200	4000	3600	3400	2600	1700	1300																		
3 HP 20 Stage SS	RHPI 4 - 550 S	38	9100	8800	8600	8300	7900	7600	7200	6800	6400	6000	5600	5000	4500	4000	3400	2900	2000	1650																			
3 HP 27 Stage SS	RHPI 4 - 675 S	32	6800	6700	6500	6400	6250	6100	5800	5600	5300	5100	4800	4500	4300	4000	3600	3400	2600	1700	1350																		
5 HP 35 Stage SS	RHPI 4 - 950 S	38	9100	9000	8900	8800	8700	8600	8500	8200	7900	7600	7200	6800	6400	6000	5600	5000	4500	4000	3400	2800	1650																
5 HP 50 Stage SS	RHPI 4/3 - 1200 S	32	6800	6700	6600	6400	6250	6100	5800	5600	5300	5100	4800	4500	4300	4000	3600	3400	2600	1700	1300																		



IS : 9283



CM/L No.6095067

**V6 SUBMERSIBLE PUMPS  
QT SERIES**



**RANGE**

- 2.0 HP to 3 HP
- Del. Size 50 to 65 mm
- Head 25 to 300 Feet
- Discharge 300 Lpm to 30 Lpm
- Voltage 415 V 3 Phase & 2 Phase, 230 V, 1 Phase

**APPLICATION**

- Pumping Water from Bores of Diameter, 6" & Above
- Irrigation for Agriculture Including Drip & Sprinkler Systems
- Public Water Supply Scheme in Urban & Rural Areas
- Industrial Water Supply
- Water Supply for Commercial Establishments like Hotels, Lodges & Hospitals

**V6 SINGLE PHASE & TWO PHASE QT SERIES SUBMERSIBLE PUMPS**

**PERFORMANCE CHART FOR RAMESH 6"(150MM) RADIAL FLOW SAND PROOF HIGH HEAD STAINLESS STEEL SUBMERSIBLE PUMP**

PUMP TYPE	Delivery size	Discharge in litres per minute at various depths in Meter/Feet																
		MTR 8 FEET 25	15 50	22 75	30 100	38 125	45 150	53 175	60 200	68 225	76 250	83 275	90 300	100 325	106 350	121 400	137 450	152 500
2 HP 3 Stage Pump QT HH	50 mm	340	300	270	220	150	60											
2 HP 4 Stage Pump QT HH	50 mm	240	210	200	180	150	120	80	30									
2 HP 5 Stage Pump QT HH	50 mm	220	200	190	170	160	140	120	100	60	30							
3 HP 6 Stage Pump QT HH	50 mm	260	240	230	210	205	180	160	140	110	80	40						
3 HP 5 Stage Pump	50 mm	320	300	270	240	180	120											
3 HP 6 Stage Pump	50 mm	270	260	235	200	165	140	100										
3 HP 8 Stage Pump	50 mm	250	240	230	210	200	185	160	125	100								
3 HP 10 Stage Pump	50 mm	230	220	210	190	170	150	140	125	110	90	75						

  **Recommended Head Range**

IS : 8034



CM/L No.3463863

**V6 RADIAL FLOW  
SUBMERSIBLE PUMPS**



**RANGE**

- 3.0 HP to 25 HP
- Del. Size 50mm
- Head 25 to 1300 Feet
- Discharge 500 to 60 Lpm
- Voltage 415 V 3 Phase & 2 Phase

**APPLICATION**

- Pumping Water from Bores of Diameter, 6" & Above
- Irrigation for Agriculture including Drip & Sprinkler Systems
- Public Water Supply Scheme in Urban & Rural Areas
- Industrial Water Supply
- Water Supply for Commercial Establishments like Hotels, Lodges & Hospitals

**PERFORMANCE CHART FOR RAMESH 6"(150MM) RADIAL FLOW SUBMERSIBLE PUMP**  
Discharge in litres per minute at various depths in Meter/Feet

PUMP TYPE R/F	Mts	15	22	30	38	45	53	60	68	76	83	90	100	106	121	137	152	167	183	198	213
2" DELIVERY	Feet	50	75	100	125	150	175	200	225	250	275	300	325	350	400	450	500	550	600	650	700
3 HP 3 Stage Pump	300	200	60																		
3 HP 5 Stage Pump	300	270	240	180	120																
3 HP 6 Stage Pump	260	235	200	165	140	100															
3 HP 8 Stage Pump	250	230	210	200	185	160	125	100	40												
3 HP 10 Stage Pump	220	210	190	170	150	140	125	110	90	75											
5 HP 5 Stage Pump	465	410	350	300	180																
5 HP 6 Stage Pump	320	280	265	250	215	100															
5 HP 8 Stage Pump	310	295	280	250	235	225	200	160	60												
5 HP 10 Stage Pump	270	260	250	240	225	210	200	175	155	130	80										
5 HP 12 Stage Pump	240	230	220	210	200	190	180	160	140	120	100	80	60								
5 HP 16 Stage Pump	220	210	200	190	180	170	160	150	140	130	110	90	80	75	50						
5 HP 24 Stage Pump	220	210	200	190	185	175	170	160	150	145	140	135	125	115	80	70	55	40	30		
6 HP 6 Stage Pump	450	420	365	350	310	235	120														
6 HP 8 Stage Pump	360	345	330	300	285	250	220	185	110												
6 HP 10 Stage Pump	300	270	260	250	235	215	205	180	160	135	90										
6 HP 12 Stage Pump	280	260	250	245	240	235	230	225	205	180	160	110	60								
6 HP 15 Stage Pump	250	240	235	230	220	210	190	180	160	150	130	115	100	80	30						
6 HP 20 Stage Pump	230	225	220	215	210	200	190	180	170	165	150	140	130	120	100	80	70	30			
6 HP 30 Stage Pump	220	210	205	200	190	180	175	170	165	160	155	150	140	130	120	110	90	75	55	40	

**V6 RADIAL FLOW  
SUBMERSIBLE PUMPS**

**PERFORMANCE CHART FOR RAMESH 6”(150MM) RADIAL FLOW SUBMERSIBLE PUMP**  
Discharge in litres per minute at various depths in Meter/Feet

PUMP TYPE R/F	Mts	15	22	30	38	45	53	60	68	76	83	90	100	106	121	137	152	167	183	198	213	244	275	305	335
2" DELIVERY	Feet	50	75	100	125	150	175	200	225	250	275	300	325	350	400	450	500	550	600	650	700	800	900	1000	1100
7.5 HP 8 Stage Pump		470	450	420	405	385	360	300	260	150															
7.5 HP 10 Stage Pump		375	360	340	330	310	290	275	255	235	210	165													
7.5 HP 12 Stage Pump		350	330	310	290	280	265	245	235	220	210	190	150	50											
7.5 HP 15 Stage Pump		300	295	280	272	270	260	250	240	230	200	180	160	140	120	100									
7.5 HP 18 Stage Pump		260	250	245	240	235	230	220	210	200	190	185	170	160	140	120	100	30							
7.5 HP 24 Stage Pump		240	240	230	225	220	210	205	200	190	185	180	175	170	150	135	120	100	80	60					
7.5 HP 35 Stage Pump		225	220	215	210	205	200	195	190	185	190	185	180	170	160	150	140	130	120	110	80	75	50		
10 HP 10 Stage Pump		485	465	430	400	385	360	330	300	270	240	180													
10 HP 12 Stage Pump		400	370	350	320	310	295	280	265	250	230	220	170	140											
10 HP 14 Stage Pump		375	375	370	365	360	350	330	315	300	280	260	240	220	180										
10 HP 16 Stage Pump		345	340	335	330	325	310	300	290	275	260	240	220	200	160	140	110								
10 HP 20 Stage Pump		300	295	290	285	280	275	270	260	250	240	230	220	210	200	180	160	130	90						
10 HP 24 Stage Pump		300	295	290	280	270	260	250	240	235	230	220	210	200	190	180	160	140	110	90	60				
10 HP 32 Stage Pump		250	245	240	235	230	225	225	220	115	210	205	200	190	180	170	160	150	140	130	90	80	60		
10 HP 40 Stage Pump		220		200			190		185			180			170		150	140	130	120	100	90	80	60	40
12.5 HP 12 Stage Pump		500	480	470	460	450	430	400	380	350	330	310	260	180											
12.5 HP 15 Stage Pump		380	375	370	360	350	330	320	300	280	270	260	240	200	160	120									
12.5 HP 18 Stage Pump		360	360	360	360	360	350	340	320	300	290	270	250	210	180	160	130	90							
12.5 HP 20 Stage Pump		350	350	350	350	345	340	330	320	310	300	290	270	260	240	200	180	140	120						

**PERFORMANCE CHART FOR RAMESH 6”(150MM) RADIAL FLOW SUBMERSIBLE PUMP**  
Discharge in litres per minute at various depths in Meter/Feet

PUMP TYPE R/F	Mts	15	22	30	38	45	53	60	68	76	83	90	100	106	121	137	152	167	183	198	213	244	275	305	335
2" DELIVERY	Feet	50	75	100	125	150	175	200	225	250	275	300	325	350	400	450	500	550	600	650	700	800	900	1000	1100
12.5 HP 24 Stage Pump		300	300	300	300	300	295	290	285	280	270	260	250	230	200	180	160	140	120	100					
12.5 HP 30 Stage Pump		260	255	250	240		235		230		225	220	210	200	190	175	160	145	130	120	100	90	50		
12.5 HP 40 Stage Pump		230		210			200		195			190		180		160	150	140	130	120	100	90	80	60	
15 HP 15 Stage Pump		510	500	480	470	460	450	440	420	400	380	360	340	320	300	180									
15 HP 18 Stage Pump		400	390	380	370	360	350	340	330	320	310	280	260	240	220	200	160	60							
15 HP 20 Stage Pump		370	365	360	355	350	345	340	335	330	310	305	280	260	250	230	200	120	90						
15 HP 24 Stage Pump		350	350	345	345	340	340	335	335	330	320	315	300	285	270	260	240	200	180	150					
15 HP 30 Stage Pump		310	300	290		285		280		275		270	265	260	250	240	230	200	185	170	150	130	110		
15 HP 40 Stage Pump		280		270		260		250		240		235	230	225	220	210	200	190	180	170	160	140	130	120	90

 Recommended Head Range

IS : 9283



CM/L No.6095067

**V6 MIXED FLOW  
SUBMERSIBLE PUMPS**



**RANGE**

- 3.0 Hp to 25 HP
- Del. Size 65 to 75mm
- Head 25 to 750 Feet
- Discharge 1350 to 180 Lpm
- Voltage 415 V 3 Phase & 2 Phase

**APPLICATION**

- Pumping Water from Bores of Diameter, 6" & Above
- Irrigation for Agriculture including Drip & Sprinkler Systems
- Public Water Supply Scheme in Urban & Rural Areas
- Industrial Water Supply
- Water Supply for Commercial Establishments like Hotels, Lodges & Hospitals

**PERFORMANCE CHART FOR RAMESH 6" (150MM) MIXED FLOW SUBMERSIBLE PUMP**  
Discharge in litres per minute at various depths in Meter/Feet

PUMP TYPE MIXED FLOW	Delivery Pipe Size	Mts 7.5 25	15 50	22.5 75	30 100	37.5 125	45 150	52.5 175	60 200	68.5 225	76 250	84 275	90 300	99 325	105 350
3 HP 2 Stage Pump	75 mm	700	360												
3 HP 3 Stage Pump	65 mm	630	450	160											
5 HP 2 Stage Pump	75 mm	960	540												
5 HP 3 Stage Pump	75 mm	720	570	375											
5 HP 4 Stage Pump	65 mm	720	680	550	400	175									
5 HP 5 Stage Pump	65 mm	680	650	510	420	200									
6 HP 3 Stage Pump	75 mm	1000	720	570											
6 HP 4 Stage Pump	75 mm	750	630	480	380										
6 HP 5 Stage Pump	65 mm	730	660	585	450	240	110								
6 HP 6 Stage Pump	65 mm	680	640	580	460	280	160								
7.5 HP 3 Stage Pump	75 mm	1300	1000	870	400										
7.5 HP 4 Stage Pump	75 mm	1020	980	830	600										
7.5 HP 5 Stage Pump	75 mm	780	750	660	540	370	180								
7.5 HP 6 Stage Pump	65 mm	750	720	690	630	540	480	320							
7.5 HP 7 Stage Pump	65 mm	700	680	660	610	550	500	380	240						
7.5 HP 8 Stage Pump	65 mm	650	630	620	580	520	480	430	370	180					

**Recomanted Head Range**

**V6 MIXED FLOW  
SUBMERSIBLE PUMPS**

**PERFORMANCE CHART FOR RAMESH 6”(150MM) MIXED FLOW SUBMERSIBLE PUMP**  
Discharge in litres per minute at various depths in Meter/Feet

PUMP TYPE MIXED FLOW	Delivery PipeSize	Mts 7.5 Feet 25	15 50	22.5 75	30 100	37.5 125	45 150	52.5 175	60 200	68.5 225	76 250	84 275	90 300	99 325	105 350
10 HP 5 Stage Pump	75 mm	1250	1150	1050	880	720	360								
10 HP 6 Stage Pump	75 mm	840	800	780	720	660	540	360							
10 HP 7 Stage Pump	65 mm	950	900	850	700	650	600	520	400	200					
10 HP 8 Stage Pump	65 mm	750	725	700	660	600	540	480	410	300					
10 HP 10 Stage Pump	65 mm	650	600	580	560	540	480	420	350	300	240	180			
12.5 HP 5 Stage Pump	75 mm	1350	1230	1120	960	880	560	280							
12.5 HP 6 Stage Pump	75 mm	1350	1200	1150	960	860	700	420	300						
12.5 HP 8 Stage Pump	75 mm	850	820	780	760	720	700	600	550	400					
12.5 HP 10 Stage Pump	65 mm	750	725	700	660	600	560	490	435	350	250	120			
12.5 HP 12 Stage Pump	65 mm	660	630	600	580	560	540	500	450	400	360	300	260	170	
15 HP 8 Stage Pump	75 mm	1100	1090	1060	1030	980	860	800	700	450	330				
15 HP 10 Stage Pump	75 mm	850	830	800	780	760	740	720	700	680	560	420	300		
15 HP 12 Stage Pump	65 mm	750	720	700	650	600	500	480	460	420	380	340	290		
15 HP 15 Stage Pump	65 mm	680	650	630	600	580	560	530	510	480	450	430	390	330	300

➔ Recommended Head Range



IS : 8034



CM/L No.3463863

**V6 STAINLESS STEEL HIGH HEAD SUBMERSIBLE PUMPS(50 FEET / STAGE)**



**RANGE**

- 2.0 HP to 25 HP
- Del. Size 50 to 65mm
- Head 25 to 1700 Feet
- Discharge 1350 to 30 Lpm
- Voltage 415 V 3 Phase & 2 Phase

**APPLICATION**

- Pumping Water from Bores of Diameter, 6” & Above
- Irrigation for Agriculture including Drip & Sprinkler Systems
- Public Water Supply Scheme in Urban & Rural Areas
- Industrial Water Supply
- Water Supply for Commercial Establishments like Hotels, Lodges & Hospitals

<b>PERFORMANCE CHART FOR RAMESH6”(150MM) SAND PROOF HIGH HEAD STAINLESS STEEL SUBMERSIBLE PUMP</b>																							
<b>Discharge in litres per minute at various depths in Meter/Feet</b>																							
PUMP TYPE R/F	Mts	DELIVERY SIZE	15	22	30	38	45	53	60	68	76	83	90	100	106	121	137	152	167	183	198	213	244
2” DELIVERY	Feet	IN mm	50	75	100	125	150	175	200	225	250	275	300	325	350	400	450	500	550	600	650	700	800
5 HP 2 Stage Pump - HH		75 MM (K-200)	800	550	300																		
5 HP 3 Stage Pump - HH		65 MM (K-150)	620	540	470	350	180																
5 HP 4 Stage Pump - HH		65 MM (K-125)	540	500	450	420	320	235	120														
5 HP 5 Stage Pump - HH		50 MM (K-100)	405	390	360	330	300	270	210	180	90												
5 HP 6 Stage Pump - HH		50 MM (K-80)	350	310	295	280	260	240	225	200	180	135	75										
5 HP 8 Stage Pump - HH		50 MM (K-60)	270	250	240	230	220	210	200	185	170	150	135	120	90	50							
5 HP 10 Stage Pump - HH		50 MM (K-50)	250	230	220	200	210	200	200	190	180	160	150	135	120	90	60						
6 HP 3 Stage Pump - HH		75 MM (K-200)	830	680	560	420	300																
6 HP 4 Stage Pump - HH		65 MM (K-150)	630	580	530	500	410	300	180														
6 HP 5 Stage Pump - HH		65 MM (K-125)	540	510	480	450	410	330	300	240	120												
6 HP 6 Stage Pump - HH		50 MM (K-100)	405	395	380	350	330	310	260	230	200	175	90										
6 HP 8 Stage Pump - HH		50 MM (K-80)	355	330	310	300	290	280	260	250	240	220	200	180	150	75							
6 HP 10 Stage Pump - HH		50 MM (K-60)	270	260	250	240	235	230	220	210	200	190	180	160	140	110	90	50					
6 HP 12 Stage Pump - HH		50 MM (K-50)	250	240	230	220		210		200		190	180	160	150	135	120	90	60				
7.5 HP 4 Stage Pump - HH		75 MM (K-200)	840	790	700	620	500	380	180														
7.5 HP 5 Stage Pump - HH		65 MM (K-150)	640	600	570	530	490	440	370	300	180												
7.5 HP 6 Stage Pump - HH		65 MM (K-125)	550	530	500	480	450	420	380	340	290	250	120										
7.5 HP 8 Stage Pump - HH		50 MM (K-100)	410	400	390	380	360	345	330	310	280	260	240	210	190	90							
7.5 HP 10 Stage Pump -HH		50 MM (K-80)	360	340	325	310	300	290	280	270	260	250	235	225	205	190	140	75					
7.5 HP 12 Stage Pump -HH		50 MM (K-60)	275	265	260	250	240	230	220	210	205	200	190	180	170	160	140	110	90	60			
7.5 HP 15 Stage Pump -HH		50 MM (K-50)	250	240	230	220		210		200		190	180	170	160	150	140	120	110	100	80	60	

**V6 STAINLESS STEEL HIGH HEAD  
SUBMERSIBLE PUMPS (50 FEET / STAGE)**

**PERFORMANCE CHART FOR RAMESH 6"(150MM) SAND PROOF HIGH HEAD STAINLESS STEEL SUBMERSIBLE PUMP**  
Discharge in litres per minute at various depths in Meter/Feet

PUMP TYPE R/F	Mts	DELIVERY SIZE	15	22	30	38	45	53	60	68	76	83	90	100	106	121	137	152	167	183	198	213	244	274	305	335	366	396	427	518
2" DELIVERY	Feet	IN mm	50	75	100	125	150	175	200	225	250	275	300	325	350	400	450	500	550	600	650	700	800	900	1000	1100	1200	1300	1400	1700
10 HP 5 Stage Pump -HH	75 MM (K-200)	850	810	780	700	630	540	450	360	180																				
10 HP 7 Stage Pump -HH	65 MM (K-150)	650	630	610	580	550	530	510	480	430	380	330	240	180																
10 HP 8 Stage Pump -HH	65 MM (K-125)	600	590	570	550	530	480	450	420	400	360	310	270	250	210															
10 HP 10 Stage Pump -HH	50 MM (K-100)	450	420	410	400	390	370	360	350	340	330	300	280	250	230	170	90													
10 HP 12 Stage Pump -HH	50 MM (K-80)	350	340	330	320	310	300	290	285	280	270	260	250	240	220	200	180	135	70											
10 HP 16 Stage Pump -HH	50 MM (K-60)	280	275	270	260	250	255	240	235	230	225	220	215	210	200	185	170	150	135	120	90	60								
10 HP 20 Stage Pump -HH	50 MM (K-50)	250	240		230		220		200		190		180		160		150	140	130	120	80	60								
12.50 HP 6 Stage Pump -HH	75 MM (K-200)	850	820	780	700	670	600	560	500	420	380	300																		
12.50 HP 8 Stage Pump -HH	65 MM (K-150)	650	630	610	590	580	560	530	520	500	480	420	380	300	190															
12.50 HP 10 Stage Pump -HH	65 MM (K-125)	550	540	535	530	520	500	480	460	450	435	420	390	340	300	240	120													
12.50 HP12 Stage Pump -HH	50 MM (K-100)	410	405	400	395	390	385	380	370	350	340	330	320	310	260	230	200	175	90											
12.50 HP 16 Stage Pump -HH	50 MM (K-80)	360	345	340	330	325	320	315	310	300	290	280	270	265	260	240	220	200	175	140	110	80								
12.50 HP20 Stage Pump -HH	50 MM (K-60)	280	275	270	260	265	260	250	240	235	230	225	220	215	210	200	195	190	180	170	150	130	100	40						
12.50 HP 25 Stage Pump -HH	50 MM (K-50)		250		240		230		220		210		200		190		180		170	160	140	120	90	70						
15 HP 7 Stage Pump -HH	75 MM (K-200)	850	840	800	770	700	670	620	580	520	460	410	360	300																
15 HP 10 Stage Pump -HH	65 MM (K-150)	640	630	620	610	600	585	570	550	530	510	490	475	440	370	300	180													
15 HP 12 Stage Pump -HH	65 MM (K-125)	550	545	540	535	530	515	500	490	480	470	450	435	420	380	340	290	250	120											
15 HP 15 Stage Pump -HH	50 MM (K-100)	410	410	405	405	400	400	395	390	380	370	360	350	330	320	300	280	240	200	190										
15 HP 18 Stage Pump -HH	50 MM (K-80)	360	360	350	345	340	330	320	310	300	290	280	275	270	275	260	230	225	220	205	190	120	75							
15 HP 25 Stage Pump -HH	50 MM (K-60)		280		270		260	255	250	245	240	235	230	225	220	215	210	205	200	195	185	160	140	130	100	60				
15 HP 30 Stage Pump -HH	50 MM (K-50)		250		240		230		220		210		200		190		180		170		160	140	120	90						
20 HP 10 Stage Pump -HH	75 MM (K-200)	850	840	830	820	810	795	780	750	700	680	630	580	540	450	360	180													
20 HP 13 Stage Pump -HH	65 MM (K-150)	650	645	640	630	620	610	600	580	575	560	540	530	520	500	460	400	340	350	160										
20 HP 16 Stage Pump -HH	65 MM (K-125)		600		595		590	580	570	560	550	540	530	500	480	450	420	400	360	310	270	250	210							
20 HP 20 Stage Pump -HH	50 MM (K-100)	450	445	440	435	430	420	415	410	400	395	390	380	370	360	350	340	330	300	280	250	230	170	90						
20 HP 25 Stage Pump -HH	50 MM (K-80)		360		355	350	345	340	330	325	320	315	310	305	300	290	285	280	270	260	250	240	220	200	180	160	140			
20 HP 34 Stage Pump -HH	50 MM (K-60)		280		270		260		250		245		240		230		220	215	210	200	180	170	160	150	120	90				
20 HP 40 Stage Pump -HH	50 MM (K-50)		250		240		230		220		210		200		190		180		170		160	140	120	75						

**PERFORMANCE CHART FOR RAMESH 6"(150MM) SAND PROOF HIGH HEAD STAINLESS STEEL SUBMERSIBLE PUMP**  
Discharge in litres per minute at various depths in Meter/Feet

PUMP TYPE R/F	Mts	DELIVERY SIZE	15	22	30	38	45	53	60	68	76	83	90	100	106	121	137	152	167	183	198	213	244	274	305	335	366	396	427	518	
2" DELIVERY	Feet	IN mm	50	75	100	125	150	175	200	225	250	275	300	325	350	400	450	500	550	600	650	700	800	900	1000	1100	1200	1300	1400	1700	
25 HP 12 Stage Pump -HH	75 MM (K-200)		850	840	830	820	800	780	740	700	680	670	650	600	560	500	420	380	300												
25 HP 16 Stage Pump -HH	65 MM (K-150)		650	640		630	620	610	600	590	585	580	570	560	530	520	500	480	420	380	300	190									
25 HP 20 Stage Pump -HH	65 MM (K-125)		600	550		540		535		530		520	510	500	480	460	450	435	420	390	340	300	240	120							
25 HP 25 Stage Pump -HH	50 MM (K-100)		450	440		430		420		410		400		390	380	370	360	350	345	335	320	290	250	230	180	120					
25 HP 30 Stage Pump -HH	50 MM (K-80)			360		345		340		330		325		320	310	300	290	280	270	260	250	240	230	210	190	165	130	100			
25 HP 40 Stage Pump -HH	50 MM (K-60)		280		275		270		265		260		250		240		235	230	225	220	215	210	200	195	190	180	170	150	120		



**VERTICAL OPENWELL SUBMERSIBLE PUMPS**



**RANGE**

- 5.0 HP to 12.5 HP
- Del. Size 65 to 75 mm
- Head 20 Feet to 400 Feet
- Discharge 1300 Lpm to 80 Lpm
- Voltage 415 V. 3 Phase

**APPLICATION**

- Irrigation for High Head, Long Distance Horizontal Pumping Application
- Open Well Pumping for Irrigation
- River & Canal Lifting Irrigation
- Sprinkler & Drip Irrigation Systems
- Pumping from Sump for High Rise Building & Industry

**PERFORMANCE CHART FOR THREE PHASE VERTICAL OPENWELL SUBMERSIBLE PUMPS**

PUMP TYPE	TYPE	PUMP SIZE IN mm	DISCHARGE IN LITRE PER MINUTES AT VARIOUS TOTAL HEADS IN FEET/MTS																		
			20 FT	40 FT	60 FT	80 FT	100 FT	120 FT	140 FT	160 FT	180 FT	200 FT	220 FT	240 FT	260 FT	280 FT	300 FT	350 FT	380 FT	400 FT	
			6 MTS	12 MTS	18 MTS	24 MTS	30 MTS	36 MTS	42 MTS	49 MTS	55 MTS	61 MTS	67 MTS	73 MTS	79 MTS	85 MTS	91 MTS	106 MTS	115 MTS	122 MTS	
3 HP 2 STAGE	VOMB 3/2	65 mm	720	600	570	480	300	150													
5 HP 2 STAGE	VOMB 5/2		860	810	720	660	570	470	330												
5 HP 3 STAGE	VOMB 5/3		750	660	640	600	550	500	390	280	150										
7.50 HP 2 STAGE	VOMB 7.50/2		930	860	800	740	620	510	420												
7.50 HP 3 STAGE	VOMB 7.50/3		860	840	820	800	750	690	630	560	480	400	260								
7.50 HP 4 STAGE	VOMB 7.50/4		750	720	690	660	630	580	530	470	400	360	250	180	80						
10 HP 4 STAGE	VOMB 10/4		980	940	900	850	810	750	730	680	610	570	520	480	400						
12.50 HP 4 STAGE	VOMB 12.50/4		1050	1030	1020	1000	960		870	810	740	700	650	540	440	300					
12.50 HP 6 STAGE	VOMB 12.50/6		860	800	770	720	690	660	630	600	570	540	500	450	420	390	360	240	120		
15 HP 4 STAGE	VOMB 15/4	75 mm	1150	1130	1100	1070	1030	1000	950	920	870	840	760	710	620	500	400				
15 HP 6 STAGE	VOMB 15/6	65 mm	900	880	860	840	830	820	810	800	780	750	730	700	680	640	550	420	300		
17.50 HP 4 STAGE	VOMB 17.50/4	75 mm	1250	1200	1150	1100	1070	1050	1000	970	920	880	800	760	680	550	460				
17.50 HP 6 STAGE	VOMB 17.50/6	65 mm	950			930			900		800	790	780	750	720	680	600	470	360	280	
20 HP 4 STAGE	VOMB 20/4	75 mm	1300		1280		1260		1250	1200	1150	1100	1000	900	800	700	500				
20 HP 6 STAGE	VOMB 20/6	65 mm	980			950			920		900	880	840	800	780	730	700	600	500	400	

➔ Recommended Head Range

## DOMESTIC PRESSURE BOOSTER



### RANGE

- 0.50 HP to 1.0 HP
- Del. Size 25 mm
- Pressure 1.50 to 4 Kg/cm<sup>2</sup>
- Discharge 7000 to 1500 Lph
- Voltage 230 V, 1 Phase

### APPLICATION

- High Pressure Application (RO Plant)
- Sprinkler Irrigation in Estate
- Pumping from Sumps for High-rise Building and Industries
- Boosting for Domestic, Commercial & Industrial Buildings
- Boiler Feed Application
- Water & Industrial Washing Purpose

### PERFORMANCE FOR DOMESTIC PRESSURE BOOSTER WITH (24 LITRES HORIZONTAL TANK)

PUMP TYPE	MODEL	PRESSURE	No. of TAPES WORKING
0.5 Hp Pressure Booster With Shallow Well Pumps	SWJ - 50/PB	1 to 3 Kg/cm	3 to 4 Taps
1.00 Hp Pressure Booster With Shallow Well Pumps	SWJ - 100/PB	1 to 3.50 Kg/cm	4 to 6 Taps
1.00 Hp Pressure Booster With 3 Stage Pumps	FM - 2/3 ST/PB	1 to 4.50 Kg/cm	9 to 15 taps

## DE WATERING PUMPS



### RANGE

- 0.50 Hp to 2 Hp
- Del. Size 25 to 50 Mm
- Pressure maximum 1.50
- Discharge 12500 to 6000 Lph
- Voltage 230 V, 1 Phase

### PERFORMANCE FOR DEWATERING PUMP

PUMP TYPE	MODEL	Pipe size mm	Operating Head Range In Feet	Discharge In LPH
0.50 HP Dewatering Pump	DW - 0.5	25	10 to 20	8500 to 6000
1.00 HP Dewatering Pump	DW - 1	50	10 to 30	10000 to 8000
2.00 HP Dewatering Pump	DW - 2	50	10 to 40	12500 to 9000

### APPLICATION :

- Rain Water Drainage
- Sewage and Waste Water Transfer
- For Drainage of Water in Construction Sites
- Transfer of Raw Sludge with Non Abbrasive Solids

**BORE WELL COMPRESSORS**



**BELT COMPRESSOR**



**MONO COMPRESSOR**

**SALIENT FEATURES:**

1. Raises water from deep wells by sending Compressed Air down PVC Pipes
2. Power source need not be close to the Bore well.
3. Raises ground water for use in Factories, Houses, Hospitals and Apartments.
4. Water outflow through delivery pipe will be pulsated and not continuous.
5. The discharge of water will greatly depend on the yield of the bore.

**RAMESH BORE WELL COMPRESSOR PUMP PERFORMANCE CHART**

Sl. No.	Total Depth	Pumping Height Feet	Lifting Height Feet	HP / WATER DISCHARGE						LTR/HR		
				1 HP	1.5 HP	2 HP	3 HP	5 HP	7.5 HP	10 HP	15 HP	15 HP
1.	100	50	50	1800	2700	3600	5400	9000	13500	18000	27000	36000
		75	25	4000	6000	8000	12000	20000	30000	40000	60000	80000
2.	150	75	75	1500	2200	3000	4500	7400	11250	15000	22500	30000
		100	50	2300	3400	4600	6900	11500	17250	23000	34500	46000
		125	25	3700	5500	7400	11000	18500	27750	37000	55500	74000
3.	200	100	100	1300	1900	2600	3900	6500	9750	13000	19500	26000
		125	75	2100	3100	4200	6300	10500	15750	21000	31500	42000
		150	50	3900	5800	7800	11700	19500	29250	39000	58500	78000
		175	25	5200	7800	10400	15600	26000	39000	52000	78000	104000
4.	300	150	150	1100	1650	2200	3300	5500	8250	11000	16500	22000
		175	125	1300	1900	2600	3900	6500	9750	13000	19000	26000
		200	100	1500	2200	3000	4500	7500	11250	15000	22500	30000
		250	50	4000	6000	8000	12000	20000	30000	40000	60000	80000
5.	400	200	200	1000	1500	2000	3000	5000	7500	10000	15000	20000
		250	150	1200	1800	2400	3600	6000	9000	12000	18000	24000
		300	100	2800	4200	5600	14000	14000	21000	28000	42000	56000
		350	50	4000	6000	8000	20000	20000	30000	40000	60000	80000

**DEPTH, COMPRESSOR HP & PIPE SIZE**

	1HP	1.5	2	3	5	7.5	10	15	20
100 to 200	1 1/4"	1 1/4"	1 1/4"	1 1/2"	2"	2 1/2"	2 1/2"	3"	3"
200 to 400	1"	1"	1"	1 1/4"	1 1/2"	2"	2"	2 1/2"	2 1/2"

**SIZE OF AIR PIPE**

1 HP to 5 HP	1/2"
7.5 HP to 10 HP	3/4"
15 HP to 20 HP	1"

\* Special type Compressors shall besupplied for above 400 Feet Bore Wells.

**ELECTRIC MOTOR**



1.5 HP 1 PHASE MOTOR



2 HP 1 PHASE FLANGE MOUNTED MOTOR



3 HP 3 PHASE MOTOR

**FLANGE MOUNTED MOTOR, 3 PHASE**  
(Class E insulation)

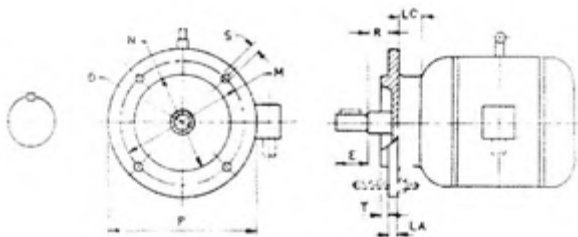

All dimensions in millimeters

FLANGE MOUNTED MOTORS, 3 PHASE													
CLASS E INSULATION													
KW RATING	MOTOR RPM	FLANGE DESIGNATION	FRAME SIZE.	M	N j6	D	E	P MAX	HOLE SIZE	S.No	T MAX	LA	LC MIN
0.25-0.37	3000 1500	F130 B	71	130±0.3	110	14j6	30	160	10	4	3.5	9	16
0.37-0.55	1000	F165 B	80	165±0.3	130	19j6	40	200	12	4	3.5	9	16
0.55-0.75	3000 1500	F165 B	80	165±0.3	130	19j6	40	200	12	4	3.5	10	20
0.75	1000	F165 B	90 S	165±0.3	130	24j6	50	200	12	4	3.5	10	20
1.5	3000	F165 B	90 L	165±0.3	130	24j6	50	200	12	4	3.5	10	20
2.2	1000 3000 1500	F215 B	100 L	215±0.3	180	28j6	60	250	15	4	4	11	24

**FOOT MOUNTED MOTOR, 3 PHASE**  
(Class E Insulation)

IS 1231 - 1974

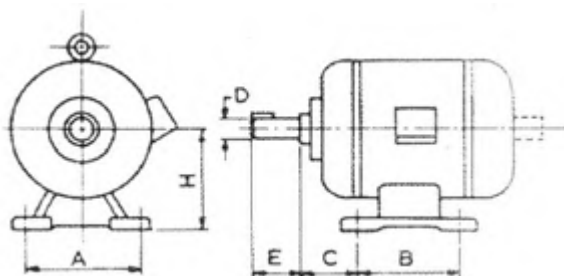

All dimensions in millimeters

FOOT MOUNTES MOTORS, 3 PHASE										
CLASS E INSULATION										
S.No	KW RATING	MOTOR RPM	FRAME No.	H TOL.-0.5	A	B	C	D	E	BOLT SIZE
1	0.37-0.55 0.55-0.75	1000 3000 1500	80	80	125	100	50	19j6	40	M8
2	0.75 1.5	1000 1500	90S 90L	90	140	100 125	56	24j6	50	M8
3	2.2	1000 3000 1500	100 L	100	160	140	63	28j6	60	M10
4	3.7	1000 3000 1500	112 M	112	190	140	70	28j6	60	M10

**BASIC DESIGN FEATURES**

- Synchronous A.C. Voltage 240 & 415 V
- Frequency 50 Hz
- Three Phase and Single Phase Winding
- Squirrel Cage Rotor
- Insulation class B/class E
- Performance as per IS 325, for 3 Phase and IS 996 for Single phase motors

**SALIENT FEARES**

- Cast-iron for Body Frame, End Shields, Bearing Shields etc.,, are made out of quality
- Graded Grey Iron Casting which assures long years of Utility
- Shaft - EN 8 steel / rotors - pressure die cast and dynamically balanced / stator core pack built from low loss electrical Grade Steel Laminations / stator winding consists of modified Polyester / polyesterimide base insulated copper wire to give high conductivity and impregnated with synthetic Resin to attain high die electric properties. Windings are tested on surge comparison tester
- Die Cast Aluminium body for frames 56 to 100
- All motors are painted with rust proof paint
- Prompt after sales service.

## DISCHARGE MEASUREMENT CHART

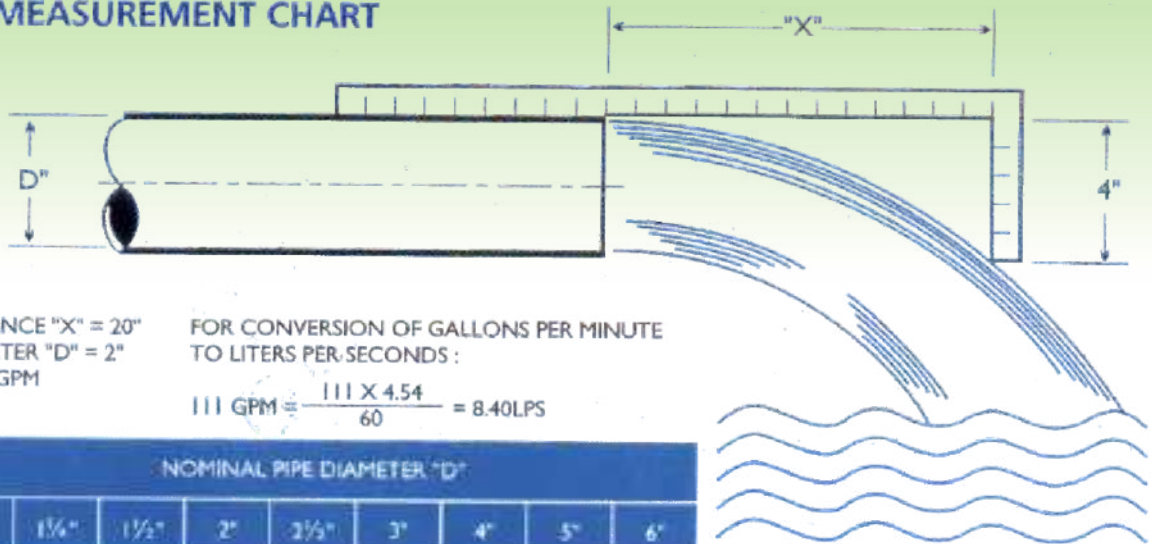

**EXAMPLE :**

HORIZONTAL DISTANCE "X" = 20"  
NORMAL PIPE DIAMETER "D" = 2"  
DISCHARGE Q = 111 GPM

FOR CONVERSION OF GALLONS PER MINUTE  
TO LITERS PER SECONDS :

$$111 \text{ GPM} = \frac{111 \times 4.54}{60} = 8.40 \text{ LPS}$$

HORIZONTAL DISTANCE "X" IN INCHES	NOMINAL PIPE DIAMETER "D"								
	1"	1 1/4"	1 1/2"	2"	2 1/2"	3"	4"	5"	6"
4	5.7	9.8	13.3	22	31	49	83	130	190
5	7.1	12.2	16.6	28	39	61	104	165	240
6	8.5	14.7	20	33	47	73	125	195	285
7	10	17.1	23.2	39	55	85	146	230	335
8	11.3	19.6	26.5	44	62	98	166	260	380
9	12.8	22	29.8	50	70	110	187	295	430
10	14.2	24.5	33.2	55	78	122	208	325	475
11	15.6	26	36.5	61	86	134	229	360	525
12	17	29	39	66	94	147	250	390	570
13	18.5	31.5	43	72	101	159	270	425	620
14	20	34	46.5	77	109	171	291	450	665
15	21.3	36.3	49.6	83	117	183	312	490	710
16	22.7	39	53	88	125	196	333	520	760
17	24.1	41.5	56.3	94	133	208	353	555	810
18	25.5	43.7	59.6	99	140	220	374	590	855
19	27	46.2	62.9	105	148	232	395	620	905
20	28.4	48.6	66.2	111	156	244	416	650	950
21	29.8	51	69.5	116	164	256	437	685	1000
22	31.2	53.5	72.8	122	172	269	457	720	1050
23	32.7	55.9	76.1	127	179	281	478	750	1095
24	34.1	58.3	79.4	133	187	293	499	780	1140
25	35.5	60.7	82.7	138	195	306	520	815	1190
26	36.9	63.2	86	144	203	318	541	845	1235
27	38.3	65.6	89.3	149	211	330	561	880	1285
28	39.8	68	92.7	155	218	342	582		
29	41.2	70.5	96	160	226	354	603		
30	42.6	72.9	99.3	166	234	367	624		
31			103	171	242	379			
32			106	177	250	391			
33			109	182	257	403			
34			113	188	265	415			
35			116	194	273	428			
36			119	199	281	440			

## CABLE SELECTION CHART

### Submersible Pumpset Cable Selection Chart For 415V - Three Phase - 50 Hz

PERFORMANCE DATA

HP	LENGTH IN METERS																				
	10	20	30	40	50	60	70	80	90	100	120	140	160	180	200	250	300	350	400	450	500
1.5	1.5	1.5	1.5	1.5	1.5	1.5	1.5	1.5	1.5	1.5	1.5	1.5	1.5	1.5	1.5	1.5	2.5	2.5	2.5	4	4
2	1.5	1.5	1.5	1.5	1.5	1.5	1.5	1.5	1.5	1.5	1.5	1.5	2.5	2.5	2.5	2.5	2.5	4	4	4	4
3	1.5	1.5	1.5	1.5	1.5	1.5	1.5	1.5	1.5	1.5	1.5	2.5	2.5	2.5	2.5	4	4	4	6	6	6
4	1.5	1.5	1.5	1.5	1.5	1.5	1.5	1.5	1.5	1.5	2.5	2.5	4	4	4	4	6	6	6	10	10
5	1.5	1.5	1.5	1.5	1.5	1.5	1.5	1.5	1.5	1.5	2.5	2.5	4	4	4	6	6	10	10	10	10
6	1.5	1.5	1.5	1.5	1.5	1.5	2.5	2.5	4	4	2.5	4	4	4	6	6	10	10	10	10	16
7.5S	2.5	2.5	2.5	2.5	2.5	2.5	2.5	2.5	2.5	2.5	4	4	6	6	6	10	10	10	16	16	16
7.5D	1.5	1.5	1.5	1.5	1.5	1.5	1.5	1.5	1.5	1.5	2.5	2.5	4	4	4	4	6	6	10	10	10
10	1.5	1.5	1.5	1.5	1.5	1.5	1.5	1.5	2.5	2.5	2.5	4	4	4	6	6	10	10	10	10	16
12.5	2.5	2.5	2.5	2.5	2.5	2.5	2.5	2.5	4	4	4	4	6	6	6	10	10	10	16	16	16
15	2.5	2.5	2.5	2.5	2.5	2.5	2.5	4	4	4	4	6	6	6	10	10	10	16	16	16	16
17.5	4	4	4	4	4	4	4	4	4	4	6	6	10	10	10	10	16	16	25	25	25
20	4	4	4	4	4	4	4	4	4	6	6	10	10	10	10	16	16	16	25	25	25
25	4	4	4	4	4	4	4	4	4	6	6	10	10	10	16	16	16	25	25	25	35
30	6	6	6	6	6	6	6	6	6	6	10	10	10	10	16	16	25	25	25	35	35
40	10	10	10	10	10	10	10	10	10	10	10	16	16	16	25	25	25	35	35	50	50
50	16	16	16	16	16	16	16	16	16	16	16	16	25	25	35	35	35	50	50	50	70
60	25	25	25	25	25	25	25	25	25	25	25	25	25	25	35	35	50	50	50	70	70
70	25	25	25	25	25	25	25	25	25	25	25	25	25	25	50	50	50	50	70	70	70
80	35	35	35	35	35	35	35	35	35	35	35	35	35	35	50	50	50	70	70	95	95

Note : 1. HP 7.5D and above are STAR / DELTA motors  
2. For STAR DELTA Starting reduce current by 1/3 for selecting suitable cable.

Example : For a 20 HP motor at 350 volts and 90 meters actual cable length, calculated length =  $(415 / 350) \times 90 = 107$  m. The size of the cable to be selected for 107m from the chart is 6 mm<sup>2</sup>.

## CABLE SELECTION CHART

### Submersible Pumpset Cable Selection Chart For 230V - Single Phase - 50Hz

PERFORMANCE DATA

HP	LENGTH IN METERS																				
	10	20	30	40	50	60	70	80	90	100	120	140	160	180	200	250	300	350	400	450	500
0.5	1.5	1.5	1.5	1.5	1.5	1.5	1.5	1.5	1.5	1.5	2.5	2.5	2.5	4	4	4	6	6	6	10	10
1	1.5	1.5	1.5	1.5	1.5	1.5	2.5	2.5	2.5	2.5	4	4	4	6	6	6	10	10	10	16	16
1.5	1.5	1.5	1.5	2.5	2.5	2.5	4	4	4	6	6	10	10	10	10	16	16	16	25	25	25
2	1.5	1.5	2.5	2.5	4	4	4	6	6	6	10	10	10	16	16	16	25	25	25	35	35
3	1.5	1.5	2.5	2.5	4	4	6	6	6	10	10	10	16	16	16	16	25	25	25	35	35
4	1.5	2.5	2.5	4	4	6	6	10	10	10	10	16	16	16	16	25	25	25	35	35	35
5	2.5	2.5	4	4	6	6	10	10	10	10	16	16	16	25	25	25	35	35	50	50	50

Conversion Table : 1m = 3.28 ft  
1 ft = 0.305 m

For other Voltages the cable size is to be selected as follows :  
Calculated length =  $(220 / \text{Volt}) \times \text{actual length}$ .

**FRICTION HEAD LOSS FOR RIGID PVC PIPES**

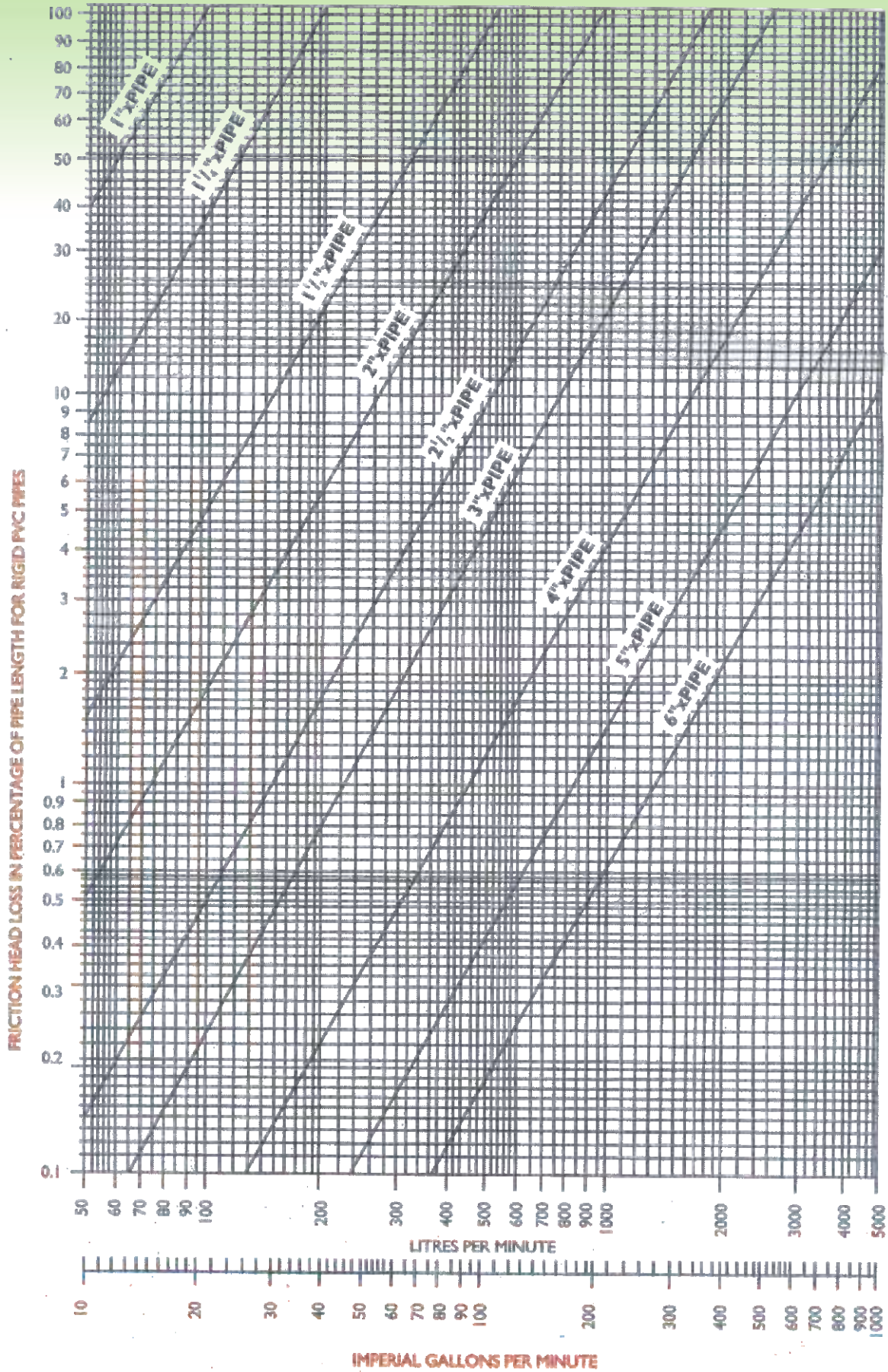

# RAMESH PUMPS MARKETING NETWORK

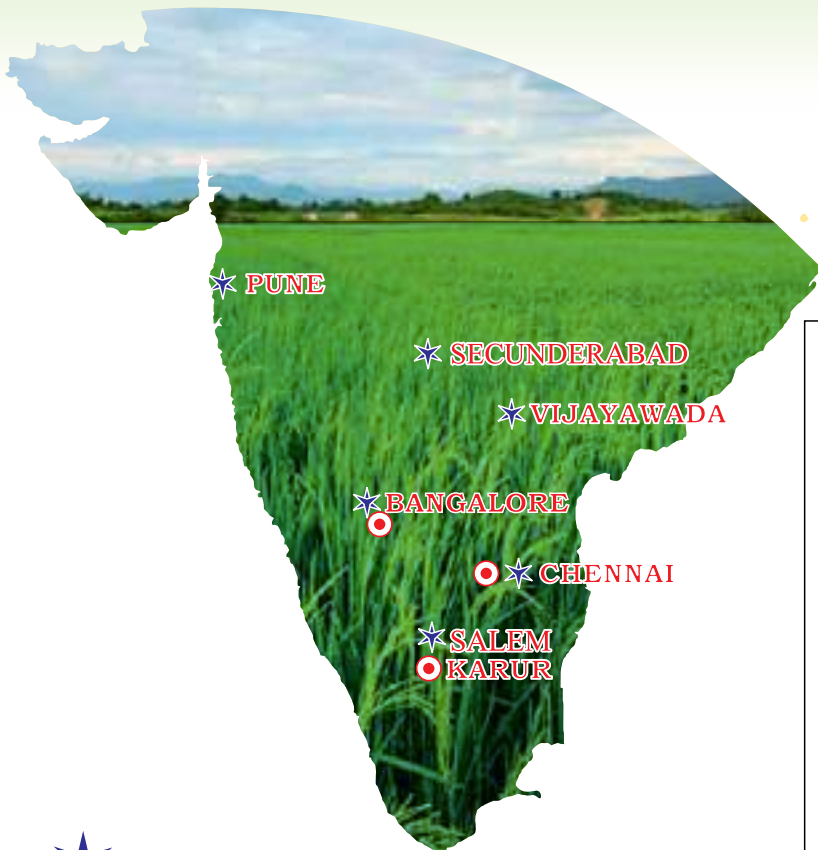

★ BRANCHES

● DISTRIBUTORS

□ DEALERS

## ADMINISTRATIVE OFFICE

Post Box No.6322  
No.1040, Bharathiyar Road,  
Pappanayiken Palayam,  
Coimbatore - 641 037  
Ph: 91 422 2249933, 2243104  
Cell: 9442633208  
Email: [marketing@rameshpump.com](mailto:marketing@rameshpump.com)  
[info@rameshpump.com](mailto:info@rameshpump.com)  
[www.rameshpump.com](http://www.rameshpump.com)

## BRANCH OFFICES

### **CHENNAI**

OLD NO;48,NEW NO:14, POST OFFICE ST  
CHENNAI - 600 001  
PH:044-511952  
CELL:9841833333  
Email:[branchchennai@rameshpump.com](mailto:branchchennai@rameshpump.com)

### **SECUNDERABAD**

H.No.5-1-524, HILL STREET,  
SECUNDERABAD - 500 003.  
PH: 040- 27711155  
Email:[branchsec@rameshpump.com](mailto:branchsec@rameshpump.com)

### **PUNE**

S.No. 177,SHOP No:2, YASHRAJ AVENUE,  
BEHIND VITTAL PETROL PUMP,  
PUNE - SASWAD ROAD,  
PHURSUNGI,PUNE - 412 308.  
PH: 020-26982978  
Email: [branchpune@rameshpump.com](mailto:branchpune@rameshpump.com)

### **BANGALORE**

SHOP No. 57/1, ANNIPURA MAIN ROAD,  
6th CROSS, NEAR AYYAPPA SWAMY TEMPLE  
SUDHAMANAGAR, BANGALORE -560 027.  
PH: 080-22222305  
Email: [branchblr@rameshpump.com](mailto:branchblr@rameshpump.com)

### **VIJAYAWADA**

No.1-4/5-25/2, PARTHASARATHI STREET,  
VIDHYADHARAPURAM,  
VIJAYAWADA - 520 012  
Email: [branchbza@rameshpump.com](mailto:branchbza@rameshpump.com)

### **SALEM**

D.No.3/196, POLICE THOTTAM,  
UTHAMASOLAPURAM POST, SALEM-636 010  
TIN No : 33612163244  
PH: 98428 12208.  
Email: [branchsalem@rameshpump.com](mailto:branchsalem@rameshpump.com)





AN ISO 9001 : 2008  
CERTIFIED COMPANY

# **Ramesh**<sup>®</sup> **PUMPS**

## **RAMESH HITECHK PUMPS PRIVATE LIMITED**

**P.B. No.6322, Coimbatore - 641 037,  
Tamilnadu, India**

E-mail : [info@rameshpump.com](mailto:info@rameshpump.com), [marketing@rameshpump.com](mailto:marketing@rameshpump.com)

### **Branches :**

- H.No. 5-1-24, Hill Street, Secunderabad - 500 003. Ph.No: 040 - 27711155.
- Shop No. 2, Yashraj Avenue, Saswad Road, Phursungi, Tal. Haveli, Pune - 412 308, Ph:020-26982978
- 1-4/5-25/2, Parthasarathi Street, Vidhyadhara Puram, Vijayawada - 520 012. Ph:0866-2413654
- 57-1 Annipura Main Road, 6<sup>th</sup> Cross Ayyappaswamy Temple, Sudhamanagar, Bengaluru - 560027. Ph: 080-22222305, 08095582534
- D.no.3/196, Police Thottam,uthamasolapuram Post, Salam-636 010 Tin No : 33612163244 Ph: 98428 12208.  
Email: [Branchsalem@rameshpump.com](mailto:Branchsalem@rameshpump.com)

### **Distributor**

48, Post Office Street, Chennai - 600 001. Ph.No: 044 - 25261221 / 25268067.

Karur : 98429 22833